

MODULAR FLOATING WORK SURFACE print and circle choices

MODULAR COLLECTION - REAR CABINETY

OPTION REFERENCE GUIDE

Upper Module (1)

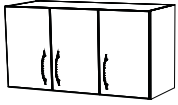

MDU426
42" Upper with 6 Shelves
\$956.00

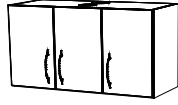

MDU42CPU
42" Upper with CPU in center/2 vents
\$1,025.00

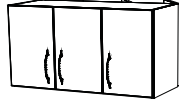

MDU42PT
42" Upper with Pass Thru & Finished Back
\$1,523.00

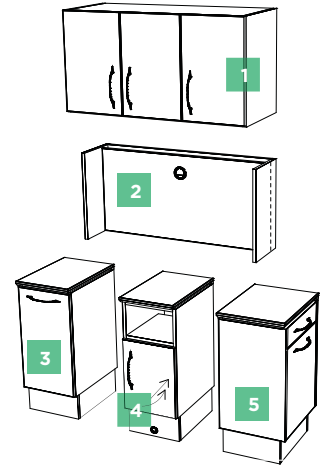

Mid-Section Module (2)

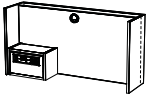

MDMPM
Mid-Section with Panel Mount Housing
\$910.00

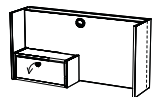

MDMHFD
Mid-Section with Half Flip Down
\$973.00

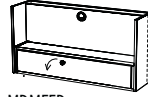

MDMFFD
Mid-Section with Full Flip Down
\$1,059.00

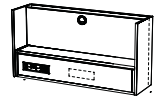

MDMUP
Mid-Section with Full Utility Panel
\$996.00

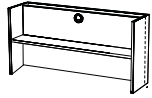

MDMWS
Mid-Section with Shelf
\$899.00

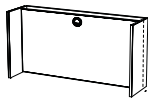

MDMWC
Mid-Section with Wire Chase
\$801.00

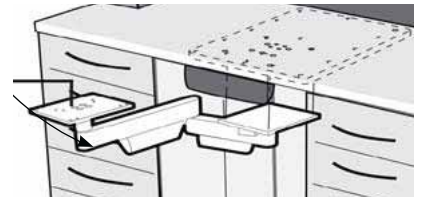

Base Module (3 & 5) (Left or Right)



MDLSC14
Single Cupboard
Laminate- \$674.00
Solid Surface - \$876.00



MDLDC14
1 Drawer with Cupboard
Laminate- \$760.00
Solid Surface - \$962.00



MDL4D14
4 Drawers
Laminate- \$900.00
Solid Surface - \$1,101.00



MDL4DE14
4 Drawer with Equipment
Laminate- \$957.00
Solid Surface - \$1,159.00

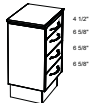

MDL4D15
4 Drawers
Laminate- \$900.00
Solid Surface - \$1,116.00



MDLPD15
Pocket Door with 1 Swing Out Tray
Laminate- \$1,075.00
Solid Surface - \$1,290.00



MDLS015
2 Drawers with Slide Out Tray
Laminate- \$1,025.00
Solid Surface - \$1,240.00



Base Module (4)



MDLSC13
Single Cupboard
Laminate- \$674.00
Solid Surface - \$861.00



MDLDD13
Double Door Utility
Laminate: \$903.00
Solid Surface: \$1,090.00



MDLDD13F
Full Height Double Door
Utility - When Arm
Assembly not present
Laminate: \$903.00
Solid Surface: \$1,090.00



MDLPD13
Pocket Door Storage
Laminate: \$903.00
Solid Surface: \$1,090.00



MDLPD13F
Full Height Pocket Door
Storage - When Arm
Assembly not present
Laminate: \$903.00
Solid Surface: \$1,090.00

ARM ASSEMBLY



MDLAL/SS
Arm Assembly with top
11" X 14" Mounting Plate
Laminate: \$1,402.00
Solid Surface: \$1,703.00

