

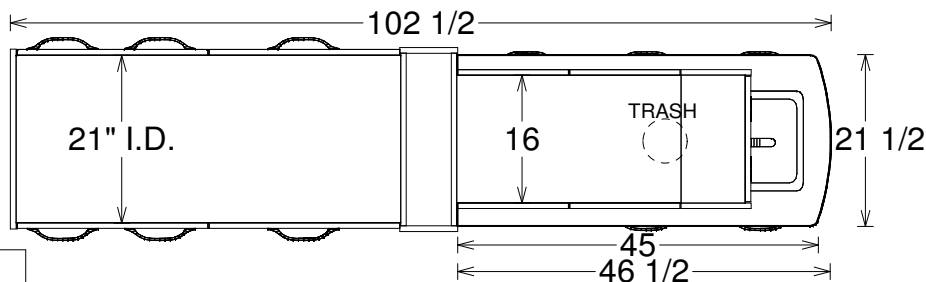

CENTER ISLAND MODULAR SERIES

PHONE: (905) 832-8311
FAX: (905) 832-0732

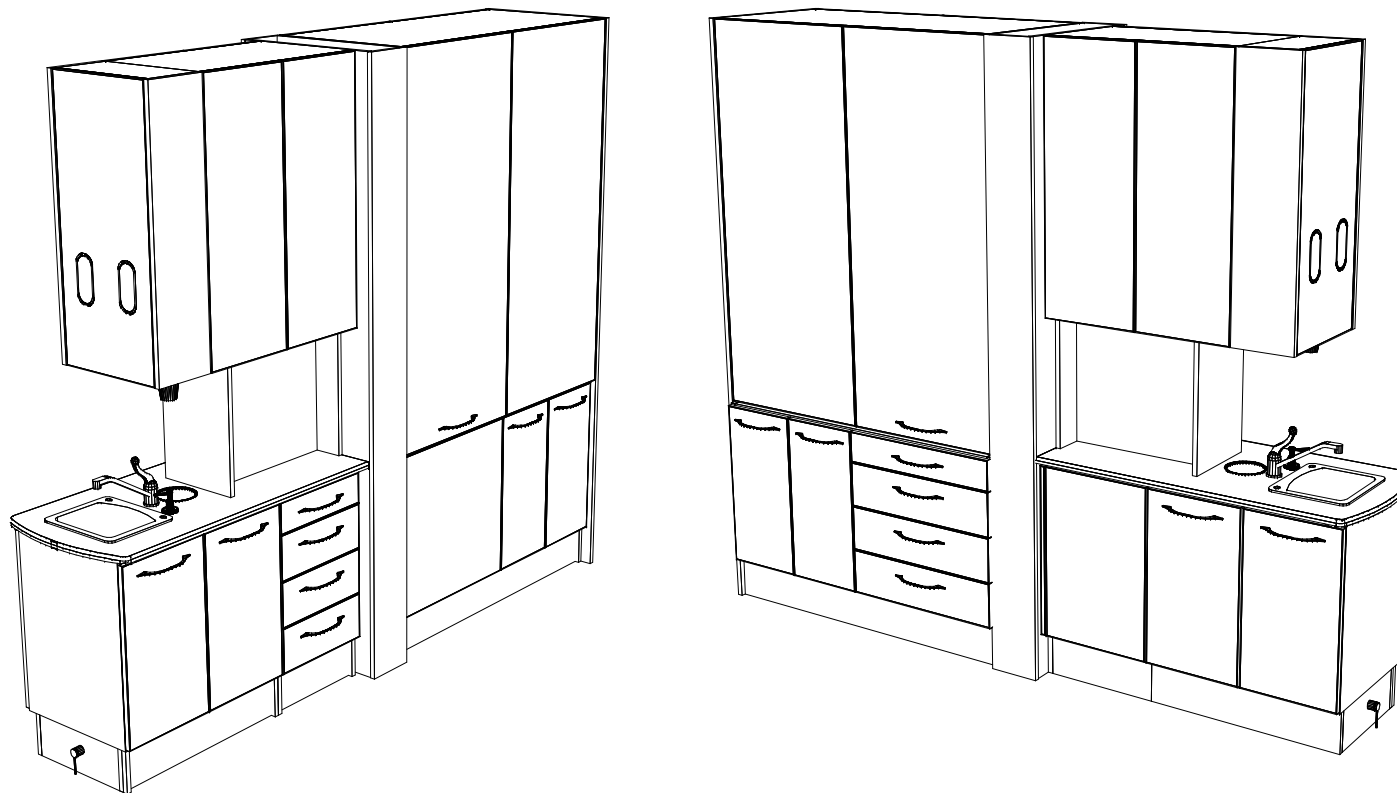

PLAN VIEW

OVERALL DIMENSIONS:

LENGTH:
DEPTH:
HEIGHT:

I CONFIRM THIS ORDER
TO BE CORRECT:

DEALER AUTHORIZED SIGNATORY / DATE

NOTE: PLUMBING & ELECTRICAL SPECS
WILL BE PROVIDED AT THE TIME OF ORDER

DEALER SIGNATURE
LOCAL PHONE
DEALER NAME / ADDRESS
ROOM #

W/O#
START DATE:
ORDER DATE:
APPROX. SHIP:
SET UPS: 2
TOP COLOUR:
-
CAB COLOUR:
-
TOE KICK = LAMINATE
HANDLES: 5" CHROME

PVC EDGE:
HARDWARE: SOFT CLOSE DOORS
FULL EXTENSION
SOFT CLOSE DRAWERS

SKETCH #: UQ22282-Q05

- OPTIONS INCLUDED:**
- MP-1 ST.ST. SINK 11"x 12 1/2"
 - MP-2 CH SINGLE LEVER FAUCET
 - MP-3 CHROME SOAP DISP.
 - MB-5R STD WASTE PAIL
 - MP-8 CUP DISP.
 - MP-12 TOWEL DISP.
 - MB-11 COUNTER WASTE DROP
 - 2 GD01 GLOVE BOX INSERTS
 - MP1775 TAPMASTER

REVISIONS		REVISIONS	
RODOLFO	09 JUN 2014	-	-
-	-	-	-
-	-	-	-