

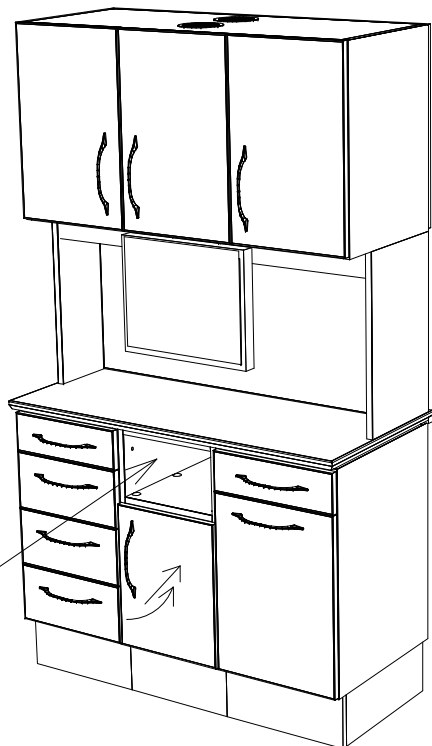

PHONE: (905) 832-8311  
 FAX: (905) 832-0732

# REAR SET-UP MODULAR SERIES



11" X 14 1/4"  
 MOUNTING PLATE  
 0023 806 ARM ASSEMBLY  
 0010 086 BLACK PLATE  
 21" X 20" WORK TABLE

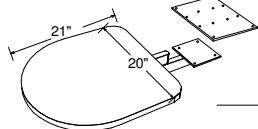

MCHSVK3 VACUUM (HVE,SE,AW SYRINGE)  
 WITH FLOATING WORK SURFACE

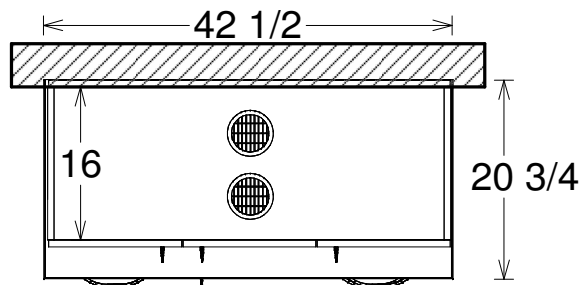

PLAN VIEW

**OVERALL DIMENSIONS:**

**LENGTH: 42 1/2"**  
**DEPTH: 20 3/4"**  
**HEIGHT: 74 1/4"**

I CONFIRM THIS ORDER  
 TO BE CORRECT:

DEALER AUTHORIZED SIGNATORY / DATE

NOTE: PLUMBING & ELECTRICAL SPECS  
 WILL BE PROVIDED AT THE TIME OF ORDER

██████████  
 ██████████  
 ████████████████████

P.O.#  
 W/O#  
 START DATE:  
 ORDER DATE:  
 APPROX. SHIP:  
 SET UPS: 1  
 TOP COLOUR:  
 -  
 CAB COLOUR:  
 -  
 TOE KICK = LAMINATE  
 HANDLES: 5" BRUSHED NICKEL

PVC EDGE:  
 HARDWARE: SOFT CLOSE DOORS  
 FULL EXTENSION  
 SOFT CLOSE DRAWERS

SKETCH #: UQ24894-Q07

OPTIONS INCLUDED:  
 MCCPN502 SLIDING MONITOR MOUNT  
 MCHSVK3 VACUUM (HVE,SE,AW SYRINGE)  
 WITH FLOATING WORK SURFACE

REVISIONS		REVISIONS	
RODOLFO	14 SEP 2015	-	-
-	-	-	-
-	-	-	-